

'C' Connectors

- 'C' Type of connectors is made from copper at least 99.9%
- Finishing with tin-plated at least 3-microns
- Dimpled or serrated to obtain high pull-out value
- Chamfered edges designed to protect the wire
- Stamped lines show proper crimp dies position

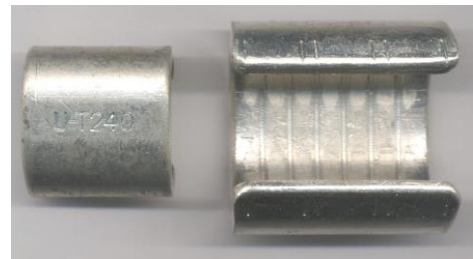
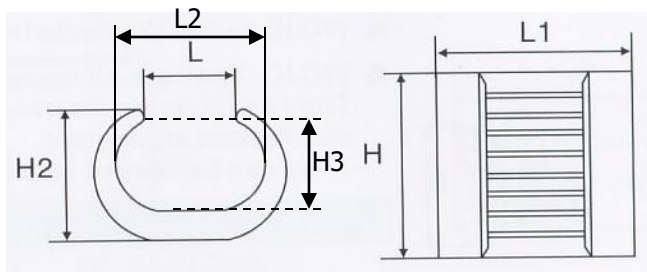

Type	L	L1	L2	H	H2	H3	Conductor Range (mm ²)
U-T44	8.3	19.0	12.4	20.0	14.0	8.1	27-44
U-T60	10.8	21.4	15.3	22.5	15.0	10.1	45-60
U-T76	9.5	24.0	16.7	22.5	17.0	10.7	61-76
U-T98	14.5	28.0	21.2	25.0	19.0	13.4	77-98
U-T122	14.0	29.3	21.3	26.0	21.0	14.5	99-122
U-T154	17.0	35.0	23.8	28.0	25.0	16.8	123-154
U-T190	17.0	36.5	28.2	35.0	25.0	17.2	155-190
U-T240	20.0	40.0	30.2	40.0	29.0	21.3	191-240
U-T288	22.0	44.0	34.2	45.0	32.0	22.9	241-288
U-T365	27.5	48.0	37.6	50.0	34.0	24.2	289-365
U-T450	28.0	56.5	41.9	60.0	41.0	27.6	366-450

* All dimensions in m.m.